

INSTRUMENTS
**TECHNO
TEST**

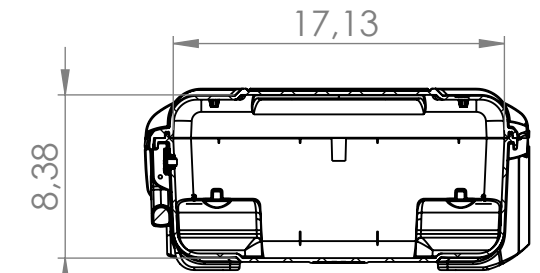

SECTION B-B

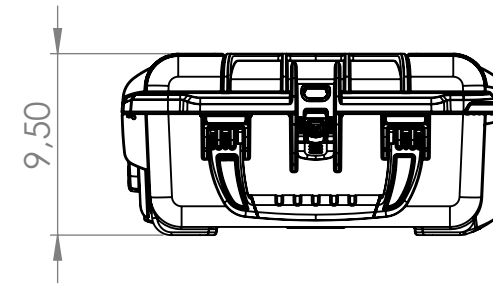
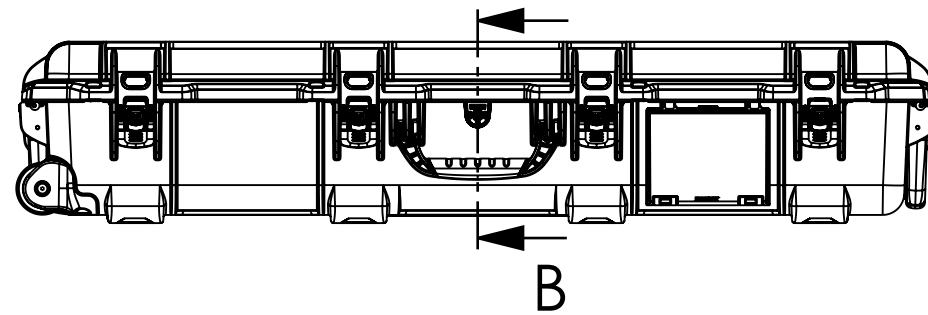
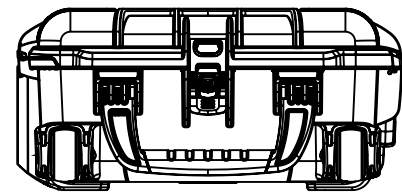
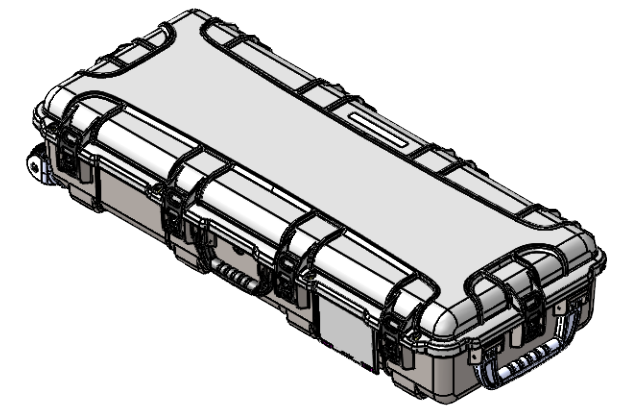
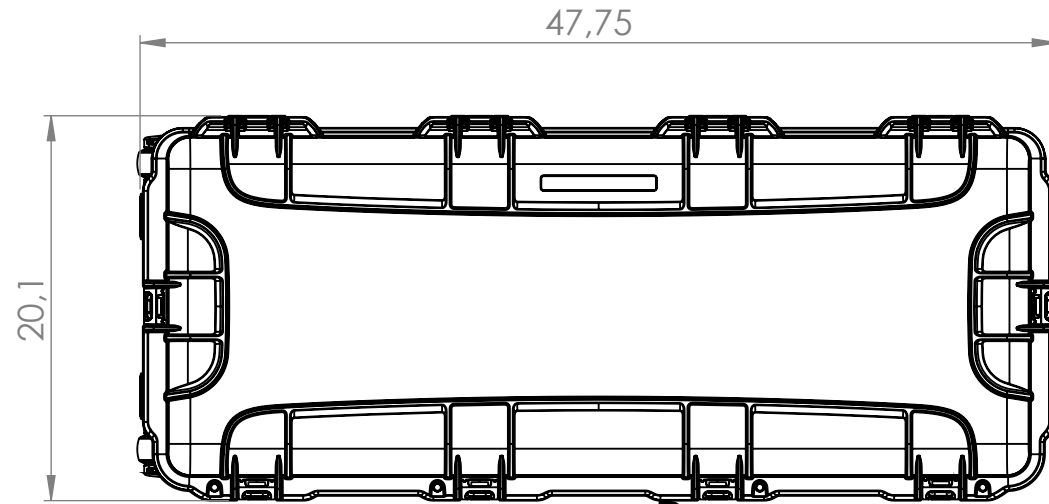
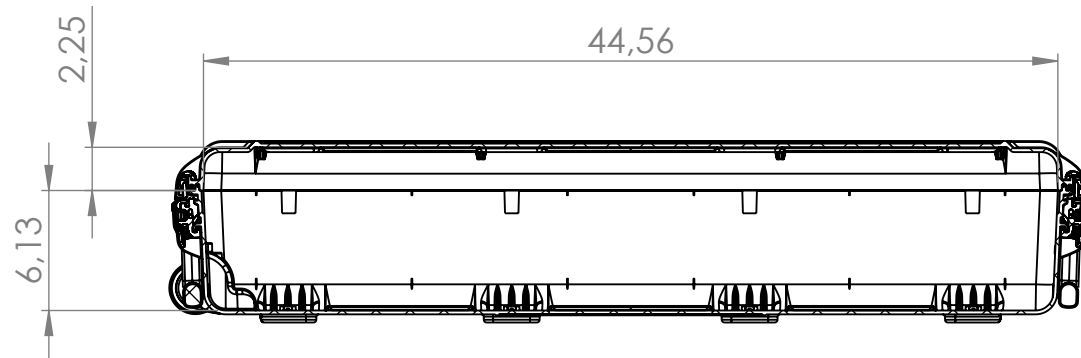
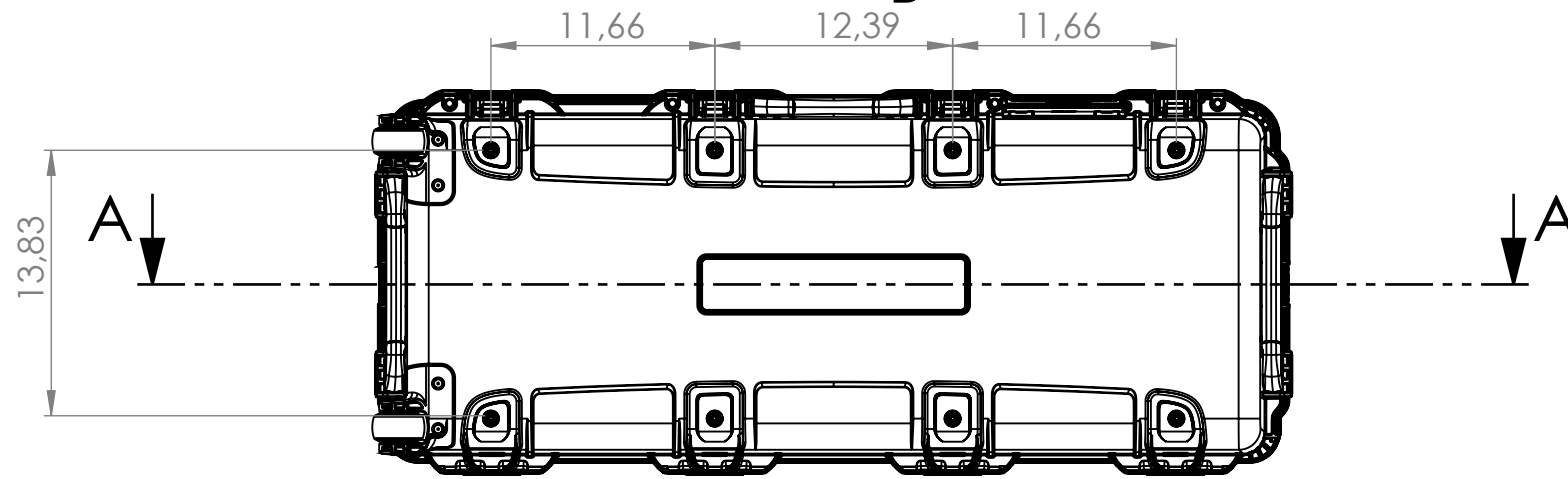

SECTION A-A

NANUK 991 SPECIFICATIONS	
Case Weight Empty	10.9kg / 24.0lbs
Interior Length	1131mm / 44.56"
Interior Width	435mm / 17.13"
Interior Height	212mm / 8.38"
Interior Lid Depth	57mm / 2.25"
Interior Base Depth	155mm / 6.13"
Exterior Length	1212mm / 47.75"
Exterior Width	511mm / 20.13"
Exterior Height	241mm / 9.50"
Master Pack Qty.	N/A
Master Pack Wt.	N/A
Max Buoyancy	N/A

UNLESS OTHERWISE SPECIFIED:

DIMENSIONS ARE IN INCHES
TOLERANCES:

X.X ± 0.1
X.XX ± 0.02
X.XXX ± 0.005

FRACTIONAL ± 1/16

ANGULAR:

X ± 1°
X.X ± 0.5°

PROPRIETARY AND CONFIDENTIAL
THE INFORMATION CONTAINED IN THIS
DRAWING IS THE SOLE PROPERTY OF
PLASTICASE INC. ANY REPRODUCTION IN
PART OR AS A WHOLE WITHOUT THE
WRITTEN PERMISSION OF PLASTICASE INC.
IS PROHIBITED.

	NAME	DATE
DRAWN BY	DB	2023-08-28
APPR. BY		
QC BY		
MATERIAL		
FINISH		
WEIGHT (Kg)		

plasticase

NANUK
PROFESSIONAL PROTECTIVE CASES

TITLE:

991_NANUK

DWG. NO.

XXX - XXXX

REV

0

DO NOT SCALE DRAWING SIZE B SCALE: 1:10 SHEET 1 OF 2

4

3

2

1

B

B

A

A

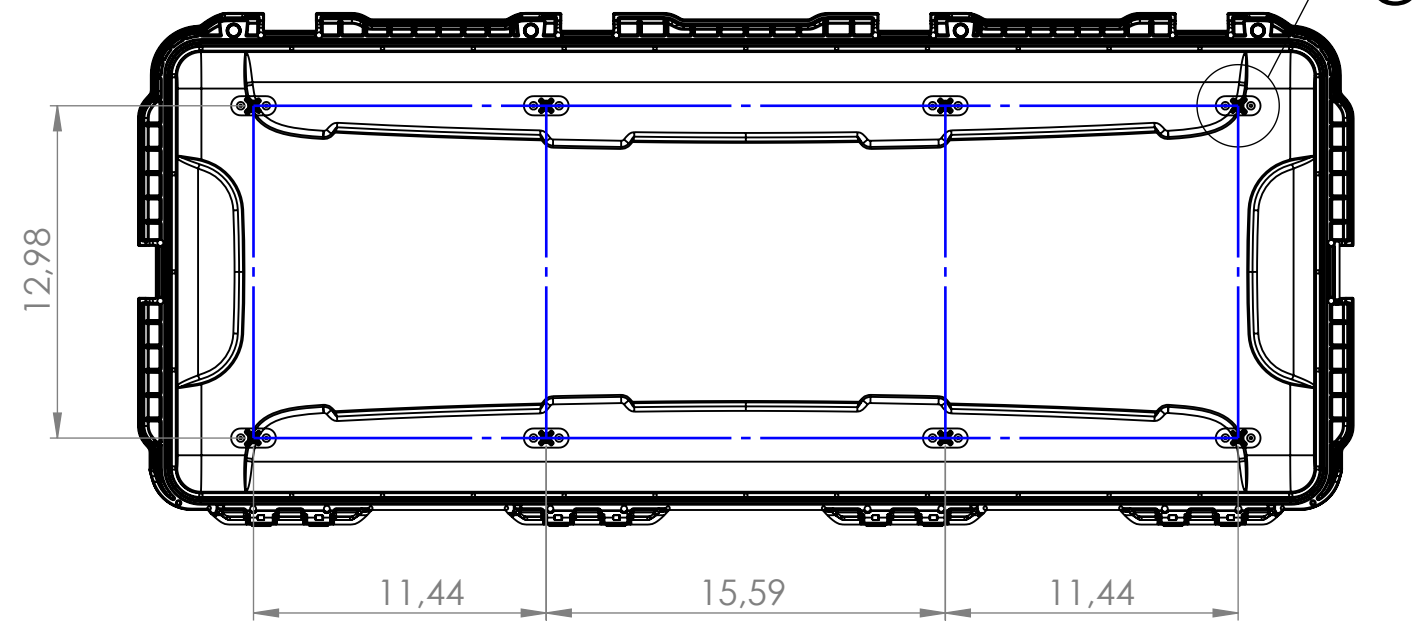

LID SCREW BOSS PATTERN

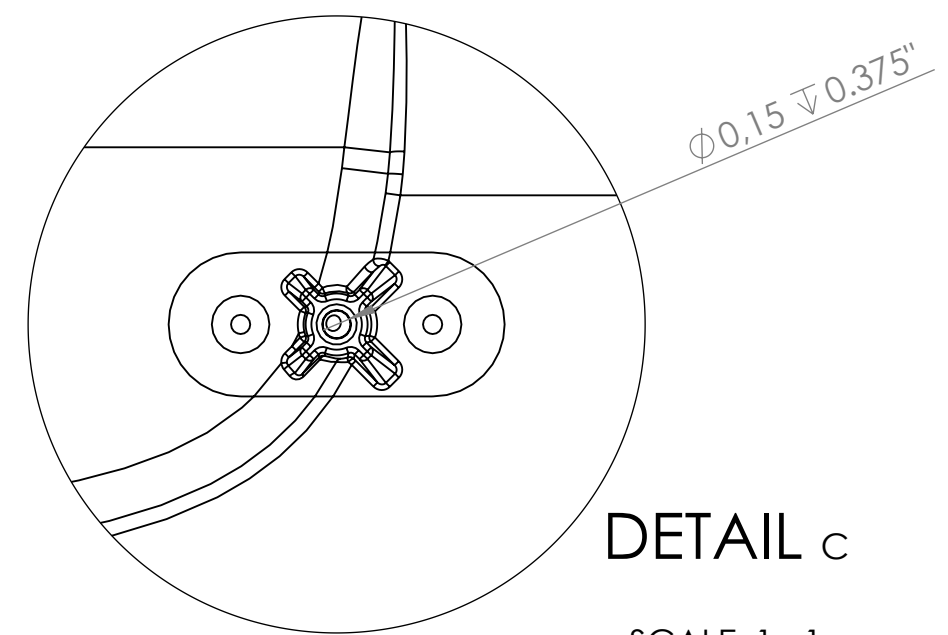

DETAIL C

SCALE 1:1

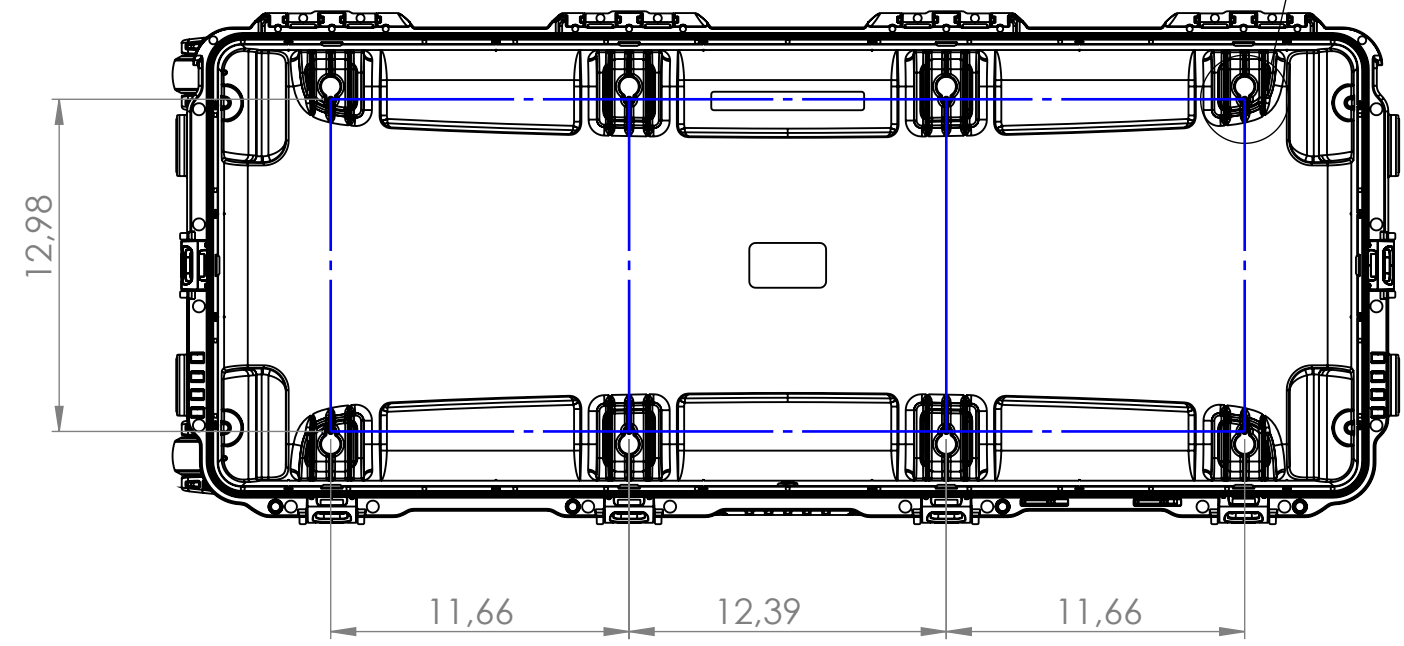

BASE SCREW BOSS PATTERN

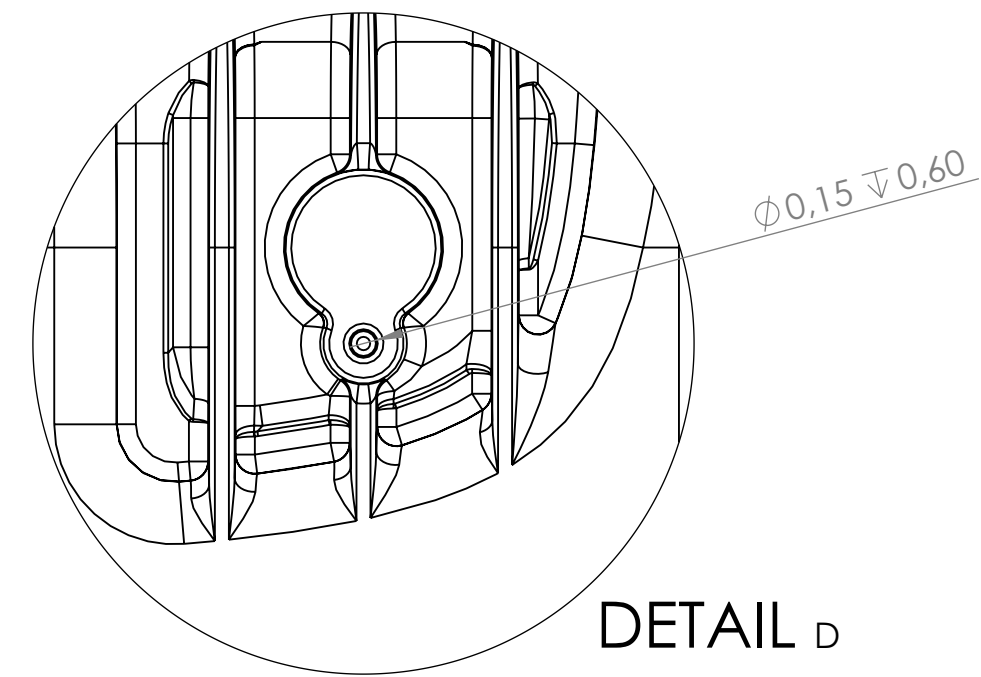

DETAIL D

SCALE 1:1

UNLESS OTHERWISE SPECIFIED:

DIMENSIONS ARE IN INCHES

TOLERANCES:

- X.X ± 0.1
- X.XX ± 0.02
- X.XXX ± 0.005

FRACTIONAL ± 1/16

ANGULAR:

- X ± 1°
- X.X ± 0.5°

PROPRIETARY AND CONFIDENTIAL

THE INFORMATION CONTAINED IN THIS DRAWING IS THE SOLE PROPERTY OF PLASTICASE INC. ANY REPRODUCTION IN PART OR AS A WHOLE WITHOUT THE WRITTEN PERMISSION OF PLASTICASE INC. IS PROHIBITED.

NAME	DB	DATE	2023-08-28
DRAWN BY			
APPR. BY			
QC BY			
MATERIAL			
FINISH			
WEIGHT (Kg)			

TITLE: 991_NANUK	
DWG. NO.	REV
XXX - XXXX	0
DO NOT SCALE DRAWING	SCALE: 1:10
SIZE B	SHEET 2 OF 2